

# Gas Jockey

**Give Yourself a Helping Hand!**

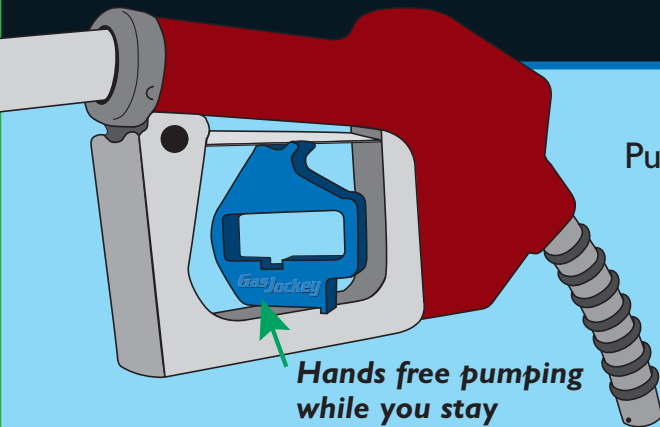

*Hands free pumping  
while you stay  
warm and dry.*

**Safety Design!**  
Pump automatically  
releases when  
tank is full!

**Stores on  
most gas  
caps!**



US Patent No.  
7,040,361

**Great for cars, RVs, trucks  
and boats!**

Check your local regulations.

## IMPORTANT SAFETY INSTRUCTIONS – READ CAREFULLY

The GasJockey is not intended to replace a properly operating fuel flow locking device. If present, use the manufacturer's fuel flow locking device incorporated into the gas pump nozzle.

Only use GasJockey with properly functioning gas pump nozzles in good repair. Damaged, deformed, or worn gas nozzle spouts may not automatically shut off. Report damaged or malfunctioning equipment to the gas station attendant.

### To Use GasJockey:

1. With vehicle engine off, place nozzle spout into gas tank filler tube.
2. With one hand depress/squeeze fuel dispensing lever to begin flow of fuel.
3. With other hand, insert angled side of GasJockey beneath and perpendicular to fuel dispensing lever until lever rests in curved depression (cradle) on top surface of the GasJockey. See illustration.

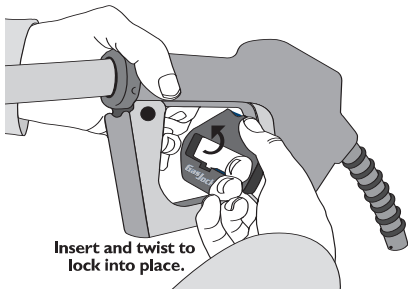

4. Release fuel dispensing lever to assure that GasJockey is properly seated and fuel is flowing. *Do not leave your vehicle unattended while fueling is in progress.*
5. When the gas pump automatically shuts off, replace nozzle and gas cap. Store GasJockey on gas cap, in filler compartment, or other convenient location for next use.

**Caution:** Misuse of GasJockey can result in gasoline spillage and hazardous conditions. Only use the GasJockey on gas pump nozzles with functioning automatic shut off sensors. Check for sensing port (small circular hole) located approximately one inch from tip of fuel filling spout. If uncertain, confirm with gas station attendant that the automatic fuel shut off sensor is properly functioning on the selected gas pump. Never use GasJockey on a nozzle that does not have a functioning automatic fuel shut off sensor.

**Warning:** Never smoke or ignite an open flame when operating a gasoline pump. Flammable fumes can ignite from sparks or flame and result in possible fire or explosion. Do not use cell phone or other electronic device while fueling.

**Important:** Never "top off" your gas tank. Most modern gas pump nozzles incorporate automatic shut off sensors which halt the flow of fuel when levels reach the sensing port on the spout. When fuel reaches the sensing port, your tank is full. Never reinsert GasJockey after the automatic shut off mechanism has been triggered.

Modern gas pump nozzles are equipped with a vapor recovery system that is designed to reduce the flow of noxious and potentially flammable fumes and pollution. When gas pump shuts off, do not attempt to continue filling tank.

The GasJockey has a docking slot that is designed to fit over the protruding grip found on many standard gas caps. If GasJockey does not easily fit over your gas cap grip, do not attempt to force it into place. Place your GasJockey in another convenient location like the fueling compartment, in your glove compartment or console storage unit.

